

CORNER RECORD

Bk 26 Pg 1
Document Number CR 2017

City of Unincorporated Eden Twp.

County of Alameda, California

Brief Legal Description PARCEL A, PARCEL MAP 4078, filed 8/08/85, 155M. 49:50

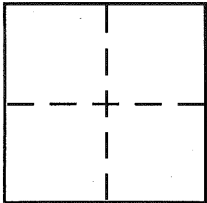

CORNER TYPE

Government Corner ☐ Control ☐
Meander ☐ Property ☒
Rancho ☐ Other ☐
Date of Survey Feb. 07, 2007

COORDINATES (Optional)

N. _____
E. _____
Zone _____ NAD27 ☐ NAD83 ☐
NAD83 Epoch _____
Elev. _____
Vert. Datum: NGVD29 ☐ NAVD88 ☐
Meas. Units: Metric ☐ Imperial ☒

Corner - Left as found ☐ Found and tagged ☐ Established ☐ Reestablished ☒ Rebuilt ☐

Identification and type of corner found: Evidence used to identify or procedure used to establish or reestablish the corner:
Held record calculated relationship of line surveyed
with the std. Ala. Co. monuments shown found in
Crest Avenue as per map of Parcel Map 4078.
(See sheet 2)

A description of the physical condition of the monument as found and as set or reset:

See Legend (Sheet 2)

SURVEYOR'S STATEMENT

This Corner Record was prepared by me or under my direction in conformance with
the Land Surveyor's Act on February 12, 2007.

Signed Gordon Lee Glenn P.L.S. or R.C.E. No. 5666

COUNTY SURVEYOR'S STATEMENT

This Corner Record was received 3-21-07

and examined and filed 5-1-07

Signed Russell R. Penland, Jr. P.L.S. or R.C.E. No. 5726

Title COUNTY SURVEYOR

County Surveyor's Comment _____

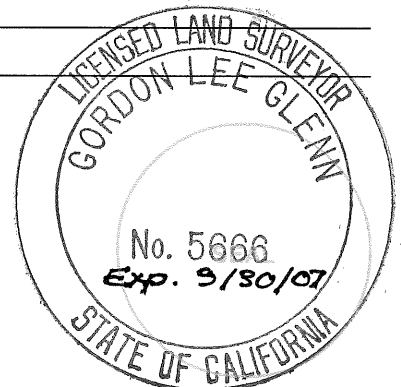

LEGEND:

- Exterior Boundary -----
- Found std. Ala. Co. monument w/bronze disk & pin ----- ●
- Set 5/8" ϕ rebar w/plastic cap L.S. 5666 ----- ○

